

Flat grinding machine FSG-2448ADIV

Model	FSG-2448ADIV
Brand	<u>CHEVALIER</u>
Condition	new
Table	1200 x 600 mm

⌚ approx. 6 months from order

€ 162.430,00

Leasing*: € 3.069,93

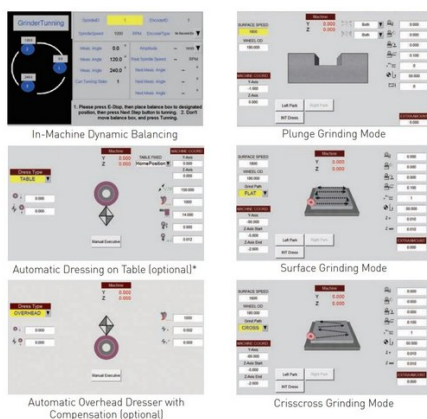

General characteristics

Grinding length	1200 mm
Distance spindle - table	730 mm
Table	1200 x 600 mm
Magnetic table	1200 x 600 mm
Table movement hydraulic	1300 mm
Table speed	5 - 30 m/min
Cross feed	0-2250 m/min
Cross feed incremental	0,001-32 mm
Max. cross feed	685 mm
Automatic vertical feed	560 mm
Vertical feed	0-675 mm/min
Spindle revs	500-2200 rpm
Spindle motor	11 kW
Hydraulic motor	5.5 kW
Cross feed motor	3.1 kW
Feed motor grinding wheel	3.1 kW
Max. workpiece weight on magnetic table	1150 kg

Max. workpiece weight on t-slot table	1600 kg
Grinding wheel dimensions	405 x 75 x 127 mm

Dimensions and weight

Length	4790 mm
Width	3207 mm
Height	2305 mm
Weight	8100 kg

Description

iSurface control with Touch screen for 3 axes fully automatic surface and plunge grinding system

10.4" TFT high resolution color control to ensure ease of operation

Rough increment, finish increment, spark out (0-9 times), and automatic grinding cycle

Cycle interrupt, flip over for part inspection & final dimensions set

Wheelhead will rise up to end, start or reference position and table parks at left or right side after cycle is completed

Display accuracy 0.0001mm

I/O diagnosis & alarm display

Max. table speed (X axis) 30 m/min

Integrated machine-body temperature control

Double V table ways are coated with Turcite-B. Table is driven by hydraulic system with cooling unit

Liner guideways coupled with precision ballscrew and AC servo motor for precise position on Y and Z axes

Automatic lubrication system with a pressure switch to detect and shut down the machine when lubrication system is down

Wheel flange with scale, clamping width 43~50 mm (1.7"~2")

Grinding wheel Ø405x75xØ127mm (Ø16"x3"xØ5") double recessed

Electromagnetic chuck 1200 x 600 mm

Automatic dressing and compensation system (mounted over the wheel)

LED machine lamp

Integrated oil cooling system for lubrication, hydraulic and spindle

Splash guard

Double-sided water baffle

Heat exchanger for electric cabinet

Oil Film Guideway system

Air purge spindle

According to "CE" regulations

Operating manual in English or German

Option (price on request):

Fully enclosed splash guard

Further information

Brochures

- [Katalog Flatschleifmaschinen Chevaler FSG-20_24ADIV](#)

Product video

- [c0q5c8aah_0.youtube](#)

Notice

Prices ex location, excluding VAT.

The [General Terms and Conditions of Delivery](#) of the Austrian Association of the Machine and Steel Construction Industry apply.

We only sell under retention of title, the goods remain our unrestricted property until they have been paid for in full.

Price changes and errors excepted.

* Monthly net leasing rate, leasing period 60 months, no down payment, 5% residual value, subject to a positive credit check. The leasing conditions of [GRENKELEASING GmbH](#) apply. Valid for lessees based in Austria.